

OREGON PUBLIC LAND CORNER REPORT / RESTORATION REPORT  
Tillamook County Surveyor's Office

SECTION: 17 & 20	TOWNSHIP: 1 South	RANGE: 9 West
------------------	-------------------	---------------

COUNTY: Tillamook	DATE: 4/20/18
-------------------	---------------

<b>CORNER DESIGNATION:</b> The West 1/16 <sup>th</sup> Corner of the South line of Section 17 and the North line of Section 20.	<b>(Please check one)</b>
	<input type="checkbox"/> Condition Report Only
	<input type="checkbox"/> Restoration
	<input checked="" type="checkbox"/> Rewitness
	<input type="checkbox"/> Unrecorded
	<input type="checkbox"/> Reset at surface
<input type="checkbox"/> Referenced Out	

**Previous Rewitnesses, Restorations and Surveys, etc..** A-1310, A-1535 (1968), A-1904 (1970), A-2176 (1971), A-2500 (1973), A-2509 (1973), A-3977 (1979), A-5945 (1990), B-535 (1967), B-1364 (1989), B-1610 (1992), B-1665 (1993), B-1794 (1994), B-3578 (2013), Rewitness Card # 203 (1972), Tillamook County Survey Records.

**Found Monument(s) and Accessories (Condition & Source):** In 1966, W.E Anderson set a 2" iron pipe for the west 1/16<sup>th</sup> corner of the South line of section 17 and the north line of section 20; prior to the construction of Latimer Road. Rewitness Card #203 witnessed the monument but no accessories were given except a note stating that Anderson had tied the monument to his center line traverse and reset the 1/16<sup>th</sup> corner after the completion of the road way. Then in 1972 Al Duncan set a 3" Brass Cap in a tile with concrete stamped "W 1/16 S17 S20 RS 793 1972" 3" above ground level with three accessories. In April of 2018 a 3" Brass Cap in tile with concrete was found but only one of the previous accessories was found.

(Rewitness Card # 203)- 18" Alder N 18° E 55.44' not found.  
 (Rewitness Card # 203)- 21" Alder N 60° W 70.15' found now 35".  
 (Rewitness Card # 203)- 4"x4"x48" post North 1.0' not found

**Monument Set (Procedures and Description):**



**New accessories set:**  
 Found Power Pole # 173105 East 94.5' from monument.  
 Found Power Pole # 173101 N 80° W 40.3' from monument.  
 Set Hat Section Post with Yellow Location Tag 2.0' North of Monument.

The Found Monument was tied directly by GPS.  
 WGS 84: N 45° 28' 40.20" Latitude  
 W 123° 49' 6.81" Longitude

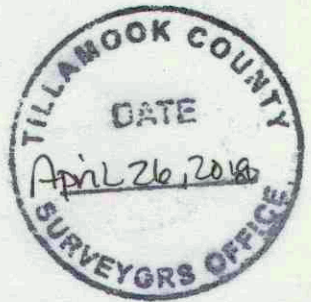

**New Bearing Trees set:** No new bearing trees set.

**Location & Comments:** ± 0.6 of a mile west of the intersection of Latimer Rd. and Sollie Smith Rd. on the north side of roadway at the toe of slope.

**Firm / Agency Tillamook County Surveyors Office**  
**Address:** 1510 3<sup>rd</sup> Street Suite C Tillamook, OR. 97141.

**Party Chief:** Joe Jensen, P.L.S. 60067, Survey Supervisor

**Notes:** Digital images taken of monument and accessories.

**Witnesses:** Michael Rice, P.L.S. 86926, Tillamook County Surveyor  
 Travis Porter, Survey Tech.

**SURVEYOR'S SEAL**

**REGISTERED PROFESSIONAL LAND SURVEYOR**

*Joseph V. Jensen*

OREGON  
 JANUARY 10, 2008  
 JOSEPH V. JENSEN  
 60067

RENEWAL DATE: 06-30-19